



MIRACLE HILL
CHINA REFRIGERATION

COPPER FITTINGS

ASME B16.22



REFRIGERATION - AIR CONDITIONING
COOLING - PLUMBING



[Contacts Here](#)

www.cnrefri.com



COPPER FITTINGS

ASME B16.22



90° SHORT RADIUS ELBOW CxC

λ Description

The 90 Degree Short Radius Elbow is used to connect two tubes from different directions, by welding.

λ Application

For refrigeration system as connectors, air conditioning and plumbing.

λ Certificates



WRAS

λ Drawing

NO.: MDRFEC01
DATE:2017-10-1

Material: >99.95% copper
Lead free: yes
Standard: AMSE B16.22

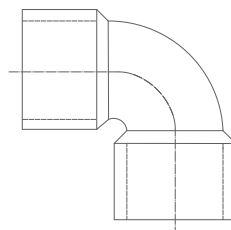

λ Specification

Code	Nominal Size
RFEC01	1/8"
RFEC02	1/4"
RFEC03	3/8"
RFEC04	1/2"
RFEC05	5/8"
RFEC06	3/4"
RFEC07	7/8"
RFEC08	1"

Code	Nominal Size
RFEC10	1 1/4"
RFEC12	1 1/2"
RFEC16	2"
RFEC20	2 1/2"
RFEC24	3"
RFEC28	3 1/2"
RFEC32	4"
RFEC40	5"

Code	Nominal Size
RFEC48	6"

1/8" 6"



COPPER FITTINGS

ASME B16.22



90° STREET ELBOW
Ftg.xC

λ Description

The 90 Degree Street Elbow is used to connect two tubes from different directions, with fitting and socket.

λ Application

For different sizes of tubes of refrigeration system as connectors, air conditioning and plumbing.

λ Certificates



WRAS

λ Drawing

NO.: MDRFEF01
DATE:2017-10-1

Material: >99.95% copper
Lead free: yes
Standard: AMSE B16.22

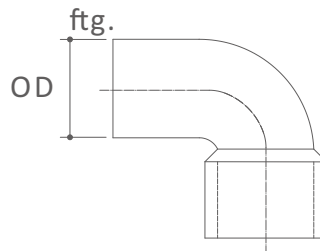

λ Specification

Code	Nominal Size
RFEF01	1/8"
RFEF02	1/4"
RFEF03	3/8"
RFEF04	1/2"
RFEF05	5/8"
RFEF06	3/4"
RFEF07	7/8"
RFEF08	1"

Code	Nominal Size
RFEF10	1 1/4"
RFEF12	1 1/2"
RFEF16	2"
RFEF20	2 1/2"
RFEF24	3"
RFEF28	3 1/2"
RFEF32	4"
RFEF40	5"

Code	Nominal Size
RFEF48	6"

1/8" 6"



COPPER FITTINGS

ASME B16.22



90° LONG RADIUS ELBOW CxC

λ Description

The 90 Degree Long Radius Elbow is used to connect two tubes from different directions, by welding.

λ Application

For refrigeration system as connectors, air conditioning and plumbing.

λ Certificates



WRAS

λ Drawing

NO.: MDRFLC01
DATE:2017-10-1

Material: >99.95% copper
Lead free: yes
Standard: AMSE B16.22

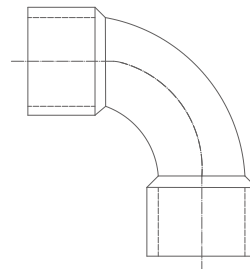

λ Specification

Code	Nominal Size
RFLC01	1/8"
RFLC02	1/4"
RFLC03	3/8"
RFLC04	1/2"
RFLC05	5/8"
RFLC06	3/4"
RFLC07	7/8"
RFLC08	1"

Code	Nominal Size
RFLC10	1 1/4"
RFLC12	1 1/2"
RFLC16	2"
RFLC20	2 1/2"
RFLC24	3"
RFLC28	3 1/2"
RFLC32	4"

Code	Nominal Size



COPPER FITTINGS

ASME B16.22



λ Description

The Long Radius Street Elbow is used to connect two tubes in a big corner of system, by welding.

λ Application

For refrigeration system as connectors, air conditioning and plumbing.

90° LONG RADIUS STREET ELBOW Ftg.xC

λ Certificates



WRAS

λ Drawing

NO.: MDRFLF01
DATE:2017-10-1

Material: >99.95% copper
Lead free: yes
Standard: AMSE B16.22

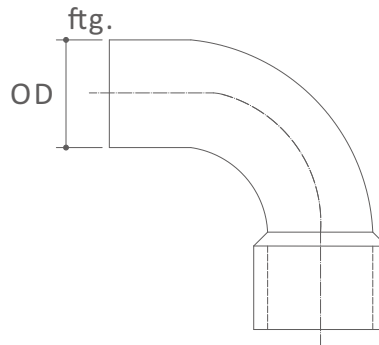

λ Specification

Code	Nominal Size
RFLF01	1/8"
RFLF02	1/4"
RFLF03	3/8"
RFLF04	1/2"
RFLF05	5/8"
RFLF06	3/4"
RFLF07	7/8"
RFLF08	1"

Code	Nominal Size
RFLF10	1 1/4"
RFLF12	1 1/2"
RFLF16	2"
RFLF20	2 1/2"
RFLF24	3"
RFLF28	3 1/2"
RFLF32	4"

Code	Nominal Size



COPPER FITTINGS

ASME B16.22



45° ELBOW CxC

λ Description

The 45 Degree Elbow is used to connect two tubes from different directions, by welding.

λ Application

For refrigeration system as connectors, air conditioning and plumbing.

λ Certificates



WRAS

λ Drawing

NO.: MDRFVC01
DATE:2017-10-1

Material: >99.95% copper
Lead free: yes
Standard: AMSE B16.22

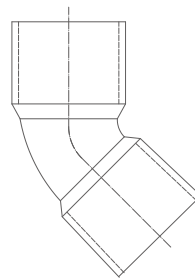

λ Specification

Code	Nominal Size
RFVC01	1/8"
RFVC02	1/4"
RFVC03	3/8"
RFVC04	1/2"
RFVC05	5/8"
RFVC06	3/4"
RFVC07	7/8"
RFVC08	1"

Code	Nominal Size
RFVC10	1 1/4"
RFVC12	1 1/2"
RFVC16	2"
RFVC20	2 1/2"
RFVC24	3"
RFVC28	3 1/2"
RFVC32	4"

Code	Nominal Size



COPPER FITTINGS

ASME B16.22



45° ELBOW CxC

λ Description

The 45 Degree Elbow is with fitting and socket, to connect two tubes from different directions, by welding.

λ Application

For refrigeration system as connectors, air conditioning and plumbing.

λ Certificates



WRAS

λ Drawing

NO.: MDRFVF01
DATE:2017-10-1

Material: >99.95% copper
Lead free: yes
Standard: AMSE B16.22

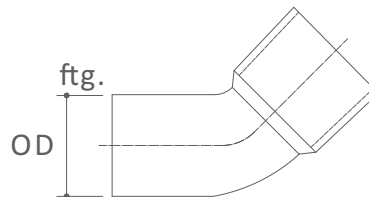

λ Specification

Code	Nominal Size
RFVF01	1/8"
RFVF02	1/4"
RFVF03	3/8"
RFVF04	1/2"
RFVF05	5/8"
RFVF06	3/4"
RFVF07	7/8"
RFVF08	1"

Code	Nominal Size
RFVF10	1 1/4"
RFVF12	1 1/2"
RFVF16	2"
RFVF20	2 1/2"
RFVF24	3"
RFVF28	3 1/2"
RFVF32	4"

Code	Nominal Size
	1/8" ————— 4"



COPPER FITTINGS

ASME B16.22



TEE CxCxC

λ Description

The Copper Tee is used to connect three tubes from different directions, by welding.

λ Application

For refrigeration system as connectors, air conditioning and plumbing.

λ Certificates



WRAS

λ Drawing

NO.: MDRFTC01
DATE:2017-10-1

Material: >99.95% copper
Lead free: yes
Standard: AMSE B16.22

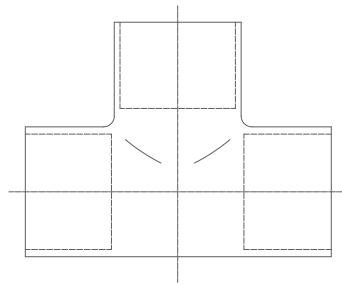

λ Specification

Code	Nominal Size
RFTC01	1/8"
RFTC02	1/4"
RFTC03	3/8"
RFTC04	1/2"
RFTC05	5/8"
RFTC06	3/4"
RFTC07	7/8"
RFTC08	1"

Code	Nominal Size
RFTC10	1 1/4"
RFTC12	1 1/2"
RFTC16	2"
RFTC20	2 1/2"
RFTC24	3"
RFTC28	3 1/2"
RFTC32	4"
RFTC40	5"

Code	Nominal Size
RFTC48	6"





COPPER FITTINGS

ASME B16.22

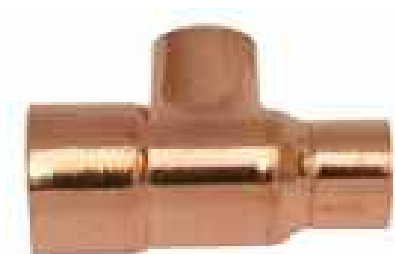

REDUCING TEE Cx C x C

λ Description

The Reducing Tee is used to connect three tubes with different sizes.

λ Application

For refrigeration system as connectors, air conditioning and plumbing.

λ Certificates



WRAS

λ Drawing

NO.: MDRFTR030202
DATE:2017-10-1

Material: >99.95% copper
Lead free: yes
Standard: AMSE B16.22

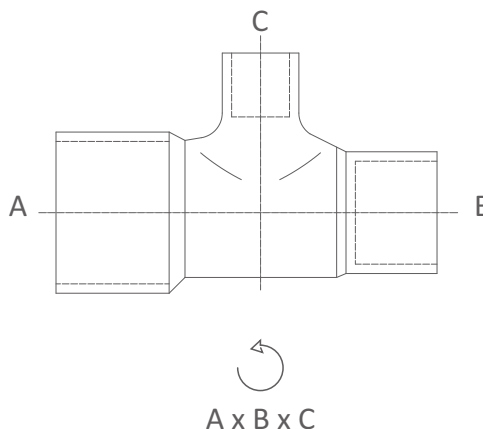

λ Specification

Code	Nominal Size
RFTR030202	3/8 x 1/4 x 1/4"
RFTR030203	3/8 x 1/4 x 3/8"
RFTR030204	3/8 x 1/4 x 1/2"
RFTR030304	3/8 x 3/8 x 1/2"
RFTR040303	1/2 x 3/8 x 3/8"
RFTR040304	1/2 x 3/8 x 1/2"
RFTR040305	1/2 x 3/8 x 5/8"
RFTR040306	1/2 x 3/8 x 3/4"

Code	Nominal Size
RFTR040308	1/2 x 3/8 x 1"
RFTR040403	1/2 x 1/2 x 3/8"
RFTR040403	1/2 x 1/2 x 3/4"
RFTR040405	1/2 x 1/2 x 5/8"
RFTR040408	1/2 x 1/2 x 1"
⚡	⚡
RFTR484832	6 x 6 x 4"

Code	Nominal Size
RFTR646432	8 x 8 x 4"

1/4" 8"



COPPER FITTINGS

ASME B16.22



P-TRAP CxC

λ Description

The P-trap is used to connect the tubes from different directions in a complex condition, by welding.

λ Application

For refrigeration system as connectors, air conditioning and plumbing.

λ Certificates



WRAS

λ Drawing

NO.: MDRFPC06
DATE:2017-10-1

Material: >99.95% copper
Lead free: yes
Standard: AMSE B16.22

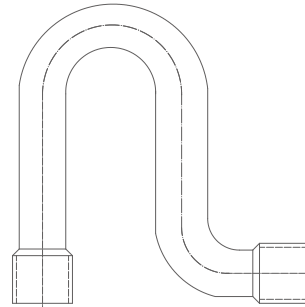

λ Specification

Code	Nominal Size
RFPC04	1/2"
RFPC05	5/8"
RFPC06	3/4"
RFPC08	1"
RFPC10	1 1/4"
RFPC12	1 1/2"
RFPC16	2"

Code	Nominal Size
------	--------------

1/8" 2"



COPPER FITTINGS

ASME B16.22



U-Bend CxC

λ Description

The U-Bend is produced in U shape, used to connect the tubes from same directions.

λ Application

For refrigeration system as connectors, air conditioning and plumbing.

λ Certificates



WRAS

λ Drawing

NO.: MDRFUC06
DATE:2017-10-1

Material: >99.95% copper
Lead free: yes
Standard: AMSE B16.22

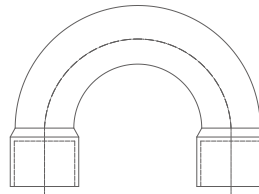

λ Specification

Code	Nominal Size
RFUC04	1/2"
RFUC05	5/8"
RFUC06	3/4"
RFUC08	1"
RFUC10	1 1/4"
RFUC12	1 1/2"
RFUC16	2"

Code	Nominal Size
------	--------------

1/8" 2"

COPPER FITTINGS

ASME B16.22



CROSS CxCxCxC

λ Description

The Cross can be connected to four directions. Widely used in the complex condition and save space.

λ Application

For refrigeration system as connectors, air conditioning and plumbing.

λ Certificates



WRAS

λ Drawing

NO.: MDRFXC06
DATE:2017-10-1

Material: >99.95% copper
Lead free: yes
Standard: AMSE B16.22

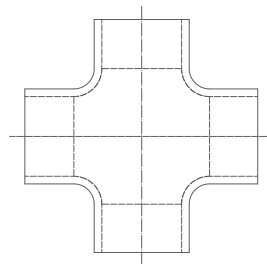

λ Specification

Code	Nominal Size
RFXC03	3/8"
RFXC04	1/2"
RFXC06	3/4"
RFXC08	1"
RFXC10	1 1/4"
RFXC12	1 1/2"
RFXC16	2"

Code	Nominal Size
	1/8" ————— 2"

COPPER FITTINGS

ASME B16.22



COUPLING w GROOVE CxC

λ Description

The Coupling with groove has a rolled stop to connect two tubes.

λ Application

For the refrigeration system as connectors, air conditioning and plumbing.

λ Certificates



WRAS

λ Drawing

NO.: MDRFIG01
DATE:2017-10-1

Material: >99.95% copper
Lead free: yes
Standard: AMSE B16.22

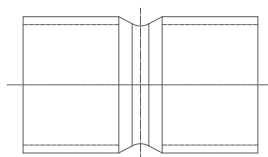

λ Specification

Code	Nominal Size
RFIG01	1/8"
RFIG02	1/4"
RFIG03	3/8"
RFIG04	1/2"
RFIG05	5/8"
RFIG06	3/4"
RFIG07	7/8"
RFIG08	1"

Code	Nominal Size
RFIG10	1 1/4"
RFIG12	1 1/2"
RFIG16	2"
RFIG20	2 1/2"
RFIG24	3"
RFIG28	3 1/2"
RFIG32	4"
RFIG40	5"

Code	Nominal Size
RFIG48	6"



COPPER FITTINGS

ASME B16.22



λ Description

The Male Adapter is with socket and screw thread, used to connect two different kinds of tubes.

λ Application

For different kinds of tubes in refrigeration system as connectors, air conditioning and plumbing.

MALE ADAPTER CxM

λ Certificates



WRAS

λ Drawing

NO.: MDRFMC02
DATE:2017-10-1

Material: >99.95% copper
Lead free: yes
Standard: AMSE B16.22

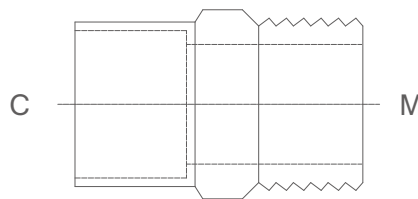

λ Specification

Code	Nominal Size
RFMC0201	1/4 x 1/8"
RFMC0303	3/8 x 3/8"
RFMC0402	1/2 x 1/4"
RFMC0403	1/2 x 3/8"
RFMC0404	1/2 x 1/2"
RFMC0406	1/2 x 3/4"
RFMC0606	3/4 x 3/4"
RFMC0808	1 x 1"

Code	Nominal Size
RFMC0806	1 x 3/4"
RFMC1008	1 1/4 x 1"
RFMC1010	1 1/4 x 1 1/4"
RFMC1012	1 1/4 x 1 1/2"
RFMC1616	2 x 2"

Code	Nominal Size
	1/4 x 1/8"
	2 x 2"



COPPER FITTINGS

ASME B16.22



λ Description

The Male Adapter is with fitting and male thread, used to connect two different kinds of tubes.

λ Application

For different kinds of tubes in refrigeration system as connectors, air conditioning and plumbing.

MALE ADAPTER Ftg.xM

λ Certificates



WRAS

λ Drawing

NO.: MDRFMF02
DATE:2017-10-1

Material: >99.95% copper
Lead free: yes
Standard: AMSE B16.22

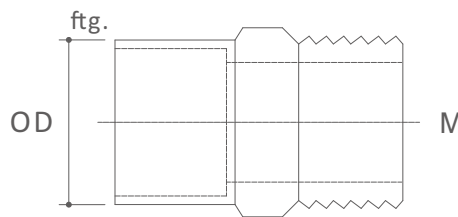

λ Specification

Code	Nominal Size
RFMF0201	1/4 x 1/8"
RFMF0303	3/8 x 3/8"
RFMF0402	1/2 x 1/4"
RFMF0403	1/2 x 3/8"
RFMF0404	1/2 x 1/2"
RFMF0406	1/2 x 3/4"
RFMF0606	3/4 x 3/4"
RFMF0808	1 x 1"

Code	Nominal Size
RFMF0806	1 x 3/4"
RFMF1008	1 1/4 x 1"
RFMF1010	1 1/4 x 1 1/4"
RFMF1012	1 1/4 x 1 1/2"
RFMF1616	2 x 2"

Code	Nominal Size
	1/4 x 1/8"
	2 x 2"

COPPER FITTINGS

ASME B16.22



λ Description

The Female Adapter is with socket and female thread, used to connect two different kinds of tubes.

λ Application

For different kinds of tubes in refrigeration system as connectors, air conditioning and plumbing.

FEMALE ADAPTER CxF

λ Certificates



WRAS

λ Drawing

NO.: MDRFFC0303
DATE:2017-10-1

Material: >99.95% copper
Lead free: yes
Standard: AMSE B16.22

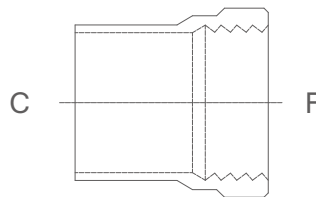

λ Specification

Code	Nominal Size
RFFC00303	3/8 x 3/8"
RFFC0402	1/2 x 1/4"
RFFC0404	1/2 x 1/2"
RFFC0406	1/2 x 3/4"
RFFC0604	3/4 x 1/2"
RFFC0606	3/4 x 3/4"
RFFC0806	1 x 3/4"
RFFC0808	1 x 1"

Code	Nominal Size
RFFC1010	1 1/4 x 1 1/4"
RFFC1212	1 1/2 x 1 1/2"
RFFC1616	2 x 2"

Code	Nominal Size
	3/8 x 3/8"
	2 x 2"



COPPER FITTINGS

ASME B16.22



λ Description

The Female Adapter is with fitting and female thread, used to connect two different kinds of tubes.

λ Application

For different kinds of tubes in refrigeration system as connectors, air conditioning and plumbing.

FEMALE ADAPTER Ftg.xF

λ Certificates



WRAS

λ Drawing

NO.: MDRFFF0303
DATE:2017-10-1

Material: >99.95% copper
Lead free: yes
Standard: AMSE B16.22

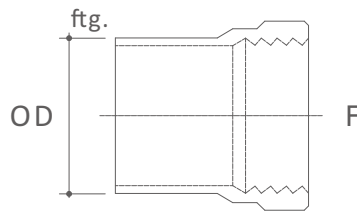

λ Specification

Code	Nominal Size
RFFF00303	3/8 x 3/8"
RFFF0402	1/2 x 1/4"
RFFF0404	1/2 x 1/2"
RFFF0406	1/2 x 3/4"
RFFF0604	3/4 x 1/2"
RFFF0606	3/4 x 3/4"
RFFF0806	1 x 3/4"
RFFF0808	1 x 1"

Code	Nominal Size
RFFF1010	1 1/4 x 1 1/4"
RFFF1212	1 1/2 x 1 1/2"
RFFF1616	2 x 2"

Code	Nominal Size
	3/8 x 3/8"
	2 x 2"